



Technical help and tips  
support line : +33 (0)4 95 04 55 90

- Components
- Dimensions and pole components
- The graphic panel : cutting format
- The graphic panel : recommended media





# Components

support line : +33 (0)4 95 04 55 90

### ● The foot

The foot is made of steel and is coated in ABS plastic. Its design allows for easy fitting of the pole. The spring fitted inside the foot enables the pole and graphic panel to be held under tension.

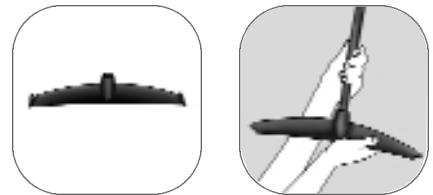

### ● The pole

Made of carbon fibre, the pole is made up of tube sections of 5 different lengths that fit into each other. The number and lengths of the sections used determine the height of the structure.

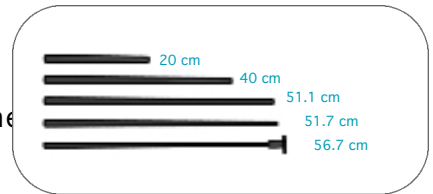

### ● The adaptor (nozzle)

The adaptor (or nozzle) is necessary when assembling double side structures of 60 cm and 110 cm in height. It must be fitted into the lower end of the pole to adapt its diameter. The smaller nozzle is for 60 cm double side structures, the larger for 110 cm high structures.

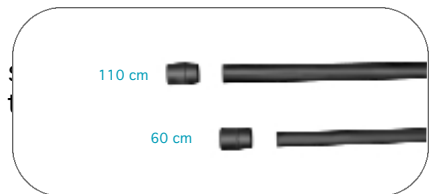

### ● The double side pole head

The pole head is an integral part of the top tube section. The bars slide easily into the grooves at the back of both graphic rods (trims).

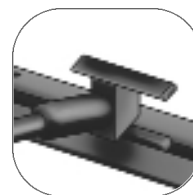

### ● The graphic rods (trims)

Two pairs of graphic rods, or trims, are necessary to assemble a double sided structure. The rods are designed to hold graphic media up to 3 mm thick. The graphic must be inserted into the clamp that runs along the length of the trim. Then, using the tool provided, tighten

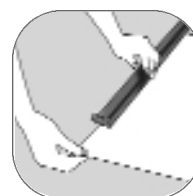
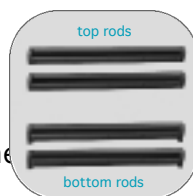



support line : +33 (0)4 95 04 55 90

## Dimensions and pole components

- Chronoexpo® 2 double side comes in 7 widths  
> 30 cm > 40 cm > 60 cm > 80 cm > 90 cm > 100 cm > 120 cm  
All widths work with all heights.
- Chronoexpo® 2 double side comes in 10 heights  
> 60 cm > 110 cm > 160 cm > 180 cm > 200 cm > 220 cm > 240 cm > 260 cm > 280 cm > 300 cm
- The height of Chronoexpo® 2 can be adjusted  
The pole is made up of tube sections that fit into each other.  
By adding or removing pole sections you can determine the height of the structure.  
The pole sections are in 5 different lengths: 56.7 cm, 51.7 cm, 51.1 cm, 40 cm and 20 cm

In order to assemble a pole shorter than purchased, simply remove sections as stipulated in the table below. To assemble a pole taller than purchased, add optional 40 cm pole sections as stipulated in the table below.

### POLE COMPONENTS

Height (in cm)	Number of pole sections				
	56.7	51.7	51.1	40	20
60	1 (a)				
110	1	1 (a)			
160	1	1	1		(b)
180	1	1	1		1
200	1	1	1	1	(b)
220	1	1	1	1	1
240	1	1	1	2	(b)
260	1	1	1	2	1
280	1	1	1	3	(b)
300	1	1	1	3	1

(a) For double sided structures of 60 cm and 110 cm in height, you must use the adaptor (or nozzle). The nozzle adapts the diameter of the pole support hole in the foot to the diameter of the pole section.

(b) ) For all heights, the pole is supplied by default with a 20 cm section. Remove this 20 cm section

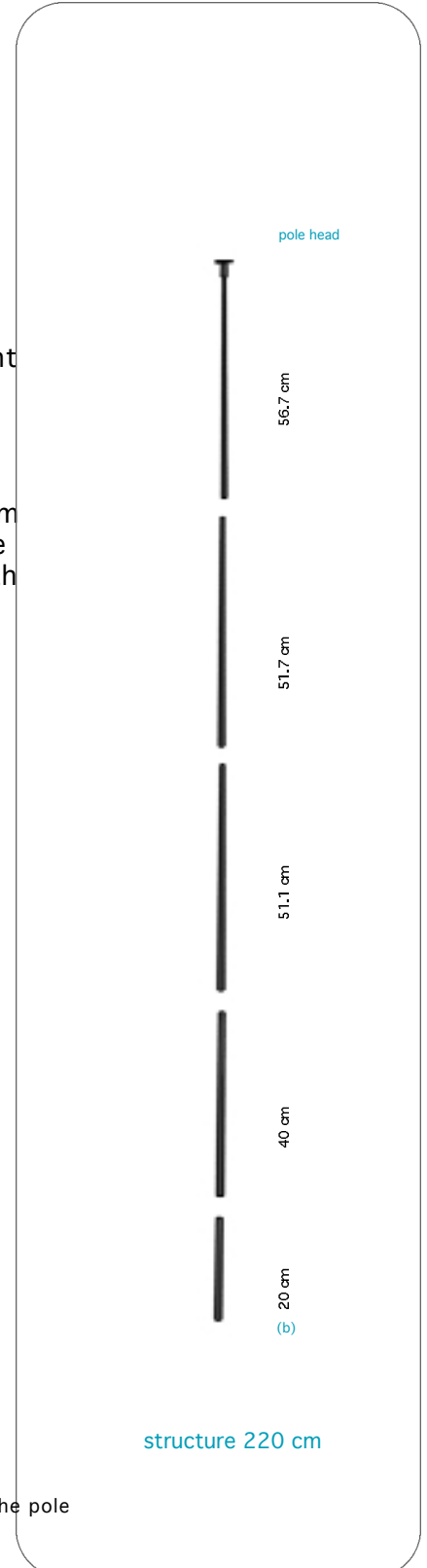



support line : +33 (0)4 95 04 55 90

The graphic panel :  
cutting format

● The height of the graphic panel is different from the height of the structure  
To ensure that the graphic panel is correctly held under tension, and that the structure remains vertical, please follow the guidelines below when cutting the panel.

● Warning : please note that 1 cm both at the top and bottom of the graphic panel will be covered by the graphic rods  
Graphic artists that design the visual must know that 1 cm at the top of the panel, as well as 1 cm at the bottom, will be covered by the graphic mounting rods. Therefore, it is necessary to avoid placing any text or graphic elements in these zones. Nevertheless, we recommend printing the

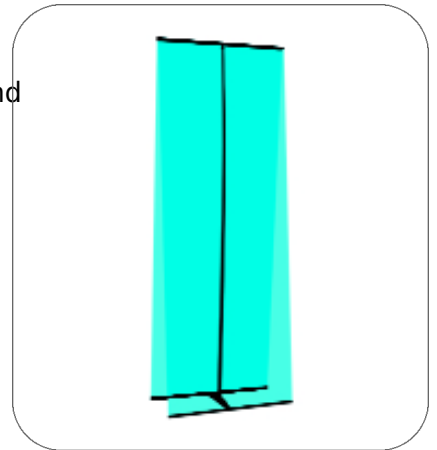

CUTTING FORMAT

Structure in cm	Cutting dimensions in cm	Visible height in cm
60	67	65
110	118	116
160	168	166
180	188	186
200	208	206
220	228	226
240	248	246
260	268	266
280	288	286
300	308	306

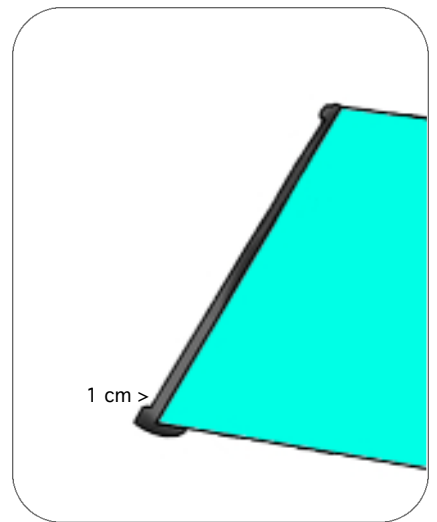



support line : +33 (0)4 95 04 55 90

The graphic panel :  
recommended media

● Single pole or double pole

The choice between these two solutions depends on the height and the width of the structure, as well as on the panel weight ( $\text{g/m}^2$ ) on which the graphic is printed.

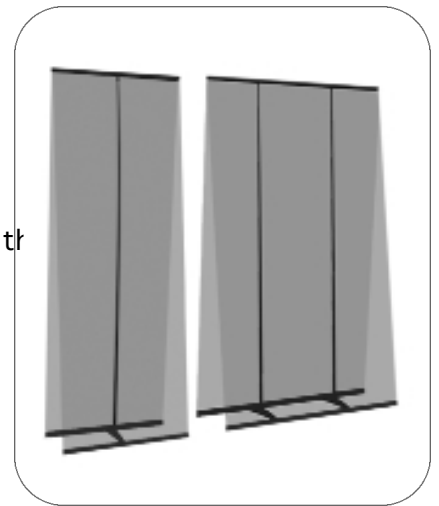

SUGGESTED MEDIA AND POLES

Structure (in cm)	Widths 30 or 40 or 60		Widths 80 or 90		Widths 100 or 120	
	Single pole	Double pole	Single pole	Double pole	Single pole	Double pole
60	up to 500 g/m <sup>2</sup> all laminates	<u>Not required</u>	up to 500 g/m <sup>2</sup> all laminates	<u>Not required</u>	up to 500 g/m <sup>2</sup> all laminates	<u>Not required</u>
110	up to 500 g/m <sup>2</sup> all laminates	<u>Not required</u>	up to 500 g/m <sup>2</sup> all laminates	<u>Not required</u>	up to 500 g/m <sup>2</sup> all laminates	<u>Not required</u>
160 - 180	up to 500 g/m <sup>2</sup> all laminates	<u>Not required</u>	up to 500 g/m <sup>2</sup> all laminates	<u>Not required</u>	up to 500 g/m <sup>2</sup> all laminates	<u>Not required</u>
200 - 220	up to 500 g/m <sup>2</sup> all laminates	<u>Not required</u>	up to 500 g/m <sup>2</sup> all laminates	<u>Not required</u>	up to 250 g/m <sup>2</sup> all laminates	up to 500 g/m <sup>2</sup> all laminates
240 - 260	up to 500 g/m <sup>2</sup> all laminates	<u>Not required</u>	up to 350 g/m <sup>2</sup> all laminates	up to 500 g/m <sup>2</sup> all laminates	up to 250 g/m <sup>2</sup> all laminates	up to 350 g/m <sup>2</sup> all laminates
280 - 300	up to 250 g/m <sup>2</sup> all laminates	up to 500 g/m <sup>2</sup> all laminates	up to 250 g/m <sup>2</sup> all laminates	up to 350 g/m <sup>2</sup> all laminates	<u>Not recommended</u>	up to 350 g/m <sup>2</sup> all laminates