



Technical help and tips  
support line : +33 (0)4 95 04 55 90

Components  
The graphic panel : recommendations





support line : +33 (0)4 95 04 55 90

## Components

### ● The foot

The foot is made of steel and is coated in ABS plastic. Its design allows for easy fitting of the pole.

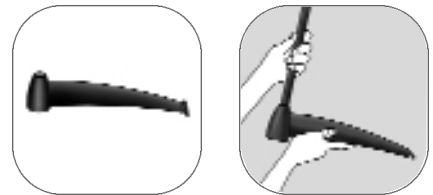

### ● The pole

Made of carbon fibre, the pole is made up of tube sections of 5 different lengths that fit into each other. The height of the cymaisa pole cannot be adjusted.

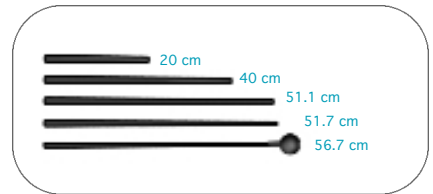

### ● The cymaisa pole head

The cymaisa pole head is a disc with a groove in which the cable passes.

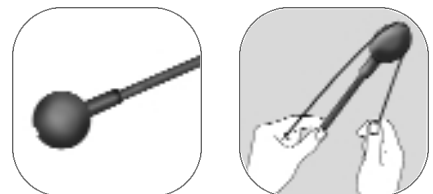

### ● The cable and the sliding hooks

The cable is made of black steel. It is fitted at both ends with a metal ball.

The steel hooks fitted onto the cable slide so that you can affix graphic panels of different heights.

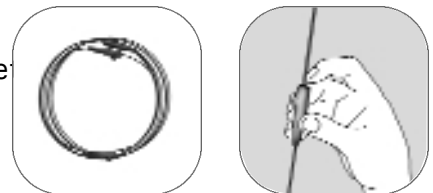

### ● The cymaisa base and the rod (or trim)

Along with the foot, these two components maintain the stability of the structure. At both ends of the base, which is screwed into the trim, is a hook that allows easy attachment of the metal ball.

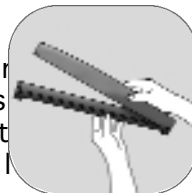



support line : +33 (0)4 95 04 55 90

The graphic panel :  
recommendations

- One single format for the structure

Height of the structure: 220 cm

Width of the base: 40 cm

- Two possibilities for the graphic panel

**Rigid graphic panel**

> Fix rings onto the back of the panel.

> Then mount the rings onto the sliding hooks assembled on the cable.

**Flexible graphic panel**

> Mount the panel onto two graphic rods (or trims).

> Fix the sliding hooks into the groove at the back of the graphic rod.

> Hold the panel under tension by sliding the hooks along the cable until the panel is taut.

